

FUTURE TRAIN STATION

LEAKES ROAD

DAVIS ROAD

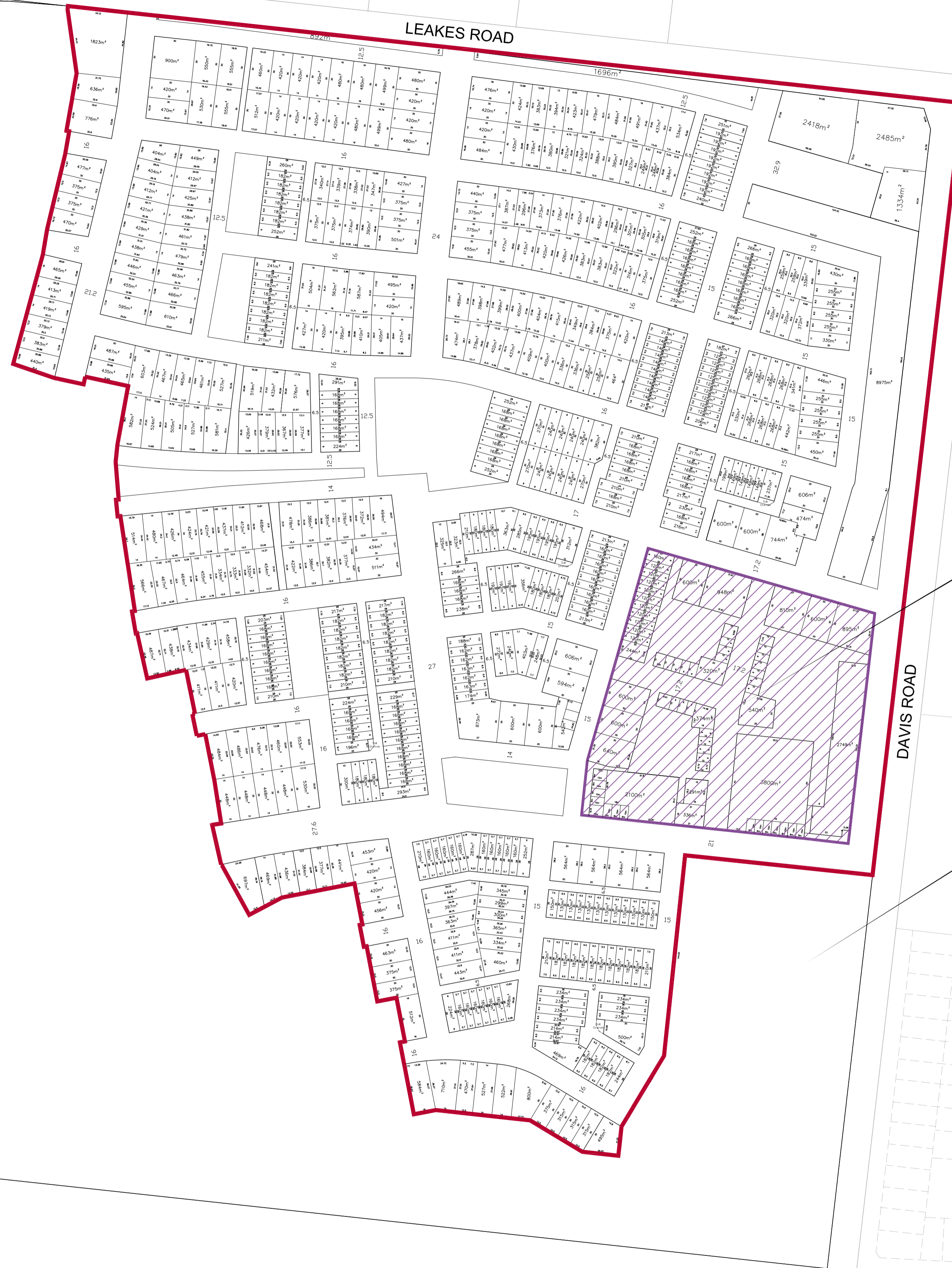

**Village Centre**  
Design subject to future planning application

**Drainage Easement**  
Design subject to future planning application

Shared Paths to be associated with drainage easement on both sides

**NOTES**

- Boundaries based on TAYLORS Survey Data.
- Layout is preliminary only and has not yet had Council/Authority feedback or approval.
- Layout & lot yield may change as a result of strategic planning outcomes yet to be finalised.
- Further requirements may be needed but not finalised until the appropriate investigations have been reported.

**DATA**

- Surrounding boundary and contour information derived from supplied VICMAP digital data.

**ASSUMPTIONS**

- Davis Road widening assumed at 20m
- Reflective of VicRoads Ultimate Intersection Detail at cnr Davis and Leakes



**HUMAN HABITATS**  
Urban Design  
155 Dorcas Street, South Melbourne, VIC 3205  
info@humanhabitats.com.au  
0415 407 311

**YOURLAND RIVERDALE VILLAGE**

**96A Application**  
Concept Plan of Subdivision

Leakes and Davis Road, Tarnet  
JOB CODE: 1003  
CONCEPT 10

DATE: 17/05/2013  
DRAFT: ROS

