

Register Search Statement - Volume 11245 Folio 285

Copyright State of Victoria. This publication is copyright. No part may be reproduced by any process except in accordance with the provisions of the Copyright Act and for the purposes of section 32 of the Sale of Land Act 1962 or pursuant to a written agreement. The information is only valid at the time and in the form obtained from the LANDATA REGD TM System. The State of Victoria accepts no responsibility for any subsequent release, publication or reproduction of the information.

REGISTER SEARCH STATEMENT (Title Search) Transfer of Land Act 1958

VOLUME 11245 FOLIO 285

Security no : 124043529956J
Produced 18/10/2012 11:30 am

LAND DESCRIPTION

Portion D Section 15 Parish of Tarnait.
PARENT TITLE Volume 09918 Folio 721
Created by instrument AH667289S 10/12/2010

REGISTERED PROPRIETOR

Istate Fee Simple
Joint Proprietors
IAN DAVID BUNTING
PAULA ALIDA BUNTING both of 990 SAYERS ROAD TARNAIT VIC 3029
U662188R 03/03/1997

ENCUMBRANCES, CAVEATS AND NOTICES

CAVEAT AH616573J 16/11/2010
Caveator
SUNVALE ASSET PTY LTD
Capacity PURCHASER/FEE SIMPLE
Lodged by
GADENS LAWYERS
Notices to
GADENS LAWYERS of 600 BOURKE STREET MELBOURNE VIC 3000

For details of any other encumbrances see the plan or imaged folio set out under DIAGRAM LOCATION below.

NOTICE Section 201UB Planning and Environment Act 1987
AH462111E 30/08/2010

DIAGRAM LOCATION

SEE TP003206B FOR FURTHER DETAILS AND BOUNDARIES

ACTIVITY IN THE LAST 125 DAYS

NIL

-----END OF REGISTER SEARCH STATEMENT-----

Additional information: (not part of the Register Search Statement)

Street Address: 990 SAYERS ROAD TARNAIT VIC 3029

DOCUMENT END

Delivered from the Landata © System by SAI Global Property Division Pty Ltd
Delivered at 18/10/2012, for Order Number 10084549. Your reference: MA7697.

G1 Application to Record Notification

Section 201UB Planning and Environment Act 1987
Use to notify the Registrar of land subject to GAIC

Privacy Collection Statement: The information from this form is collected by the Registrar of Titles and is used for the purpose of maintaining publicly searchable registers and indexes.

AH462111E
30/08/2010 \$0 201UB

Read this before you start

- 1 Fill page 1 online
- 2 Print form single sided
- 3 Sign with a blue or black pen

4. Does the lodging party have a customer code?

No Go to question 5
Yes What is the customer code? Reference
14273H 0/10/4728

Purpose

The Growth Areas Authority applies to the Registrar of Titles to record a notification on the folio(s) of the Register described at item 1 that a growth areas infrastructure contribution may be payable.

5. Lodging party details

Lodging party

1. What land is subject to GAIC?

Land Title 1		
Volume		folio
Land Title 2		
Volume		folio

Given Name(s)
Family Name/
Company Name

Growth Areas Authority

Phone

Other Land Titles

See attached list

Address

No. Street Suburb Postcode

2. Signature/s

Growth Areas Authority

Signature

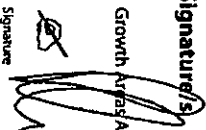
Peter Sawyer

Name of Signatory

3. Date (dd/mm/yyyy)

30/08/2010

You may lodge this form in two ways:

1. In person

Level 9, 570 Bourke Street
Melbourne 3000

2. By mail

P.O. Box 500
East Melbourne 3002

AH462111E

30/08/2010 \$0 20108



Voi/Fol	Voi/Fol	Voi/Fol	Voi/Fol	Voi/Fol	Voi/Fol	Voi/Fol	Voi/Fol	Voi/Fol	Voi/Fol	Voi/Fol
139/601	4594/635	8162/673	8541/356	8739/787	8842/134	8900/292				
267/330	4658/415	8204/400	8541/357	8739/788	8842/135	8900/293				
267/340	4787/225	8210/486	8547/501	8739/789	8842/136	8900/294				
451/167	4953/483	8215/864	8547/977	8739/792	8842/137	8900/295				
489/649	4964/677	8218/032	8547/978	8739/793	8850/019	8900/296				
638/571	5350/889	8231/931	8547/980	8739/794	8857/981	8900/297				
647/382	5507/303	8269/013	8547/981	8739/795	8865/396	8900/298				
824/704	5600/900	8294/813	8569/350	8739/796	8869/771	8900/299				
1031/051	5804/612	8309/576	8576/382	8739/797	8869/772	8900/300				
1178/419	5910/840	8310/126	8576/384	8742/589	8869/773	8900/301				
1226/165	5990/959	8310/127	8581/146	8742/590	8874/217	8900/302				
1233/491	6015/996	8321/655	8592/852	8742/591	8877/852	8900/303				
1251/127	6020/949	8349/370	8592/853	8742/592	8877/853	8900/304				
1264/604	6043/546	8368/998	8592/876	8742/593	8888/081	8900/305				
1505/901	6122/329	8378/211	8592/884	8742/594	8889/985	8900/306				
1978/595	6135/000	8378/214	8592/885	8742/595	8894/157	8900/307				
2041/108	6160/901	8378/215	8600/690	8742/596	8894/158	8900/308				
2090/953	6168/483	8378/216	8603/842	8747/084	8894/694	8900/309				
2220/934	6195/943	8378/217	8610/993	8747/085	8894/695	8900/310				
2534/731	6229/723	8378/218	8611/461	8747/086	8894/696	8900/311				
2534/732	6244/608	8378/219	8622/411	8752/088	8894/697	8900/312				
2759/636	6298/444	8378/220	8622/412	8755/679	8894/698	8900/313				
2770/963	6330/985	8378/221	8622/988	8755/751	8894/701	8900/314				
2862/217	6437/282	8378/222	8622/989	8755/752	8894/702	8900/315				
2946/200	6565/988	8378/223	8622/990	8755/777	8894/703	8900/316				
3099/656	6581/174	8378/226	8624/292	8755/778	8898/105	8900/317				
3099/675	6647/398	8379/883	8624/293	8758/355	8900/259	8900/318				
3132/225	6765/868	8379/885	8624/296	8766/992	8900/261	8903/211				
3188/558	6765/869	8383/697	8624/297	8772/323	8900/262	8907/122				
3352/400	6765/870	8389/202	8634/128	8790/501	8900/263	8907/619				
3481/102	6911/045	8403/987	8646/467	8806/545	8900/264	8908/714				
3487/224	6993/407	8411/050	8677/020	8807/338	8900/265	8908/715				
3509/629	7186/016	8412/208	8678/242	8807/339	8900/266	8908/716				
3619/739	7194/648	8421/635	8683/243	8807/340	8900/267	8909/407				
3674/635	7275/803	8427/825	8683/252	8812/559	8900/268	8909/685				
3702/397	7277/277	8436/031	8692/737	8816/670	8900/269	8919/214				
3724/752	7505/065	8436/502	8693/511	8816/671	8900/270	8919/215				
3879/632	7532/137	8457/262	8693/513	8816/672	8900/271	8922/593				
3915/946	7649/107	8459/277	8693/514	8819/811	8900/272	8923/838				
3919/701	7656/039	8475/919	8696/244	8819/812	8900/273	8923/839				
3920/919	7659/121	8480/663	8698/895	8819/813	8900/274	8923/840				
3948/518	7662/117	8486/685	8708/229	8819/814	8900/276	8923/841				
3953/529	7785/042	8492/903	8708/464	8819/815	8900/277	8924/425				
4012/379	8041/132	8492/904	8708/779	8820/924	8900/279	8930/457				
4019/684	8041/399	8492/906	8709/198	8836/829	8900/280	8938/771				
4019/685	8041/400	8502/405	8715/897	8836/830	8900/282	8942/740				
4024/650	8066/282	8502/406	8732/244	8836/831	8900/283	8942/741				
4129/609	8092/571	8510/185	8733/402	8838/412	8900/284	8950/971				
4242/224	8096/369	8510/303	8733/403	8842/127	8900/285	8953/965				
4252/349	8106/720	8510/304	8738/528	8842/128	8900/286	8954/141				
4377/374	8106/721	8521/038	8739/591	8842/129	8900/287	8954/142				
4382/319	8129/406	8532/426	8739/592	8842/130	8900/288	8954/143				
4392/391	8141/370	8536/860	8739/593	8842/131	8900/289	8954/144				
4477/215	8149/589	8536/861	8739/594	8842/132	8900/290	8954/145				
4557/371	8162/010	8536/862	8739/786	8842/133	8900/291	8954/146				

AH46211E

30/09/2010 10 2008



VollFol	VollFol	VollFol	VollFol	VollFol	VollFol	VollFol	VollFol	VollFol
8954/147	9005/336	9109/390	9225/930	9375/943	9443/122	9501/212		
8954/148	9007/431	9109/391	9227/202	9375/947	9443/123	9501/252		
8954/149	9010/204	9109/392	9227/203	9375/948	9443/124	9501/253		
8954/151	9019/365	9109/393	9227/630	9375/951	9443/125	9501/255		
8954/152	9022/268	9109/394	9227/631	9381/442	9443/126	9503/048		
8954/153	9026/900	9109/395	9227/632	9389/077	9443/127	9504/968		
8954/154	9042/583	9109/396	9231/277	9391/274	9443/128	9508/441		
8954/155	9045/320	9109/397	9231/540	9396/903	9443/129	9509/863		
8954/156	9045/942	9109/398	9231/982	9396/904	9443/131	9509/864		
8954/157	9047/883	9109/399	9242/592	9399/506	9443/132	9516/669		
8954/158	9052/355	9109/400	9254/011	9399/609	9443/133	9522/663		
8954/159	9052/576	9109/401	9255/485	9399/692	9443/134	9522/664		
8954/160	9070/222	9109/402	9256/159	9402/918	9443/135	9523/453		
8954/161	9070/222	9109/403	9256/160	9405/500	9443/136	9523/503		
8954/162	9070/223	9109/404	9268/683	9413/116	9443/137	9523/631		
8954/163	9070/225	9109/405	9286/465	9413/117	9443/138	9535/088		
8954/164	9070/226	9109/406	9286/466	9413/118	9443/139	9541/064		
8954/165	9070/705	9109/407	9290/653	9415/811	9443/140	9541/065		
8954/166	9070/706	9109/408	9297/658	9418/765	9443/149	9541/066		
8954/167	9070/707	9109/409	9297/966	9425/584	9443/891	9541/067		
8954/168	9070/708	9109/410	9304/796	9426/840	9443/892	9541/068		
8954/169	9070/709	9109/411	9304/797	9426/841	9443/893	9545/891		
8954/170	9070/710	9114/376	9304/798	9426/842	9443/894	9545/892		
8954/171	9070/711	9114/377	9304/799	9426/843	9443/895	9551/105		
8954/172	9070/712	9116/690	9304/800	9427/544	9449/203	9551/528		
8954/174	9070/714	9116/691	9304/801	9427/545	9449/296	9551/550		
8954/175	9070/715	9116/692	9304/802	9427/546	9449/754	9557/785		
8954/176	9070/716	9116/693	9310/308	9427/547	9450/276	9562/454		
8964/441	9070/717	9121/387	9312/072	9427/548	9450/277	9562/576		
8965/616	9070/718	9127/837	9313/324	9427/549	9450/644	9562/578		
8966/832	9070/719	9127/838	9316/884	9427/550	9450/645	9562/579		
8968/228	9070/721	9127/839	9317/330	9427/551	9455/030	9567/415		
8972/099	9070/722	9127/840	9317/333	9427/552	9455/031	9567/620		
8973/033	9072/040	9129/521	9325/244	9428/252	9460/163	9567/622		
8975/169	9075/435	9132/749	9330/230	9431/902	9465/003	9580/507		
8975/839	9075/436	9132/777	9330/231	9433/597	9472/269	9597/854		
8975/840	9075/462	9135/164	9330/233	9436/966	9474/075	9597/855		
8975/877	9075/463	9153/820	9330/234	9436/967	9474/640	9599/616		
8993/430	9075/464	9153/821	9332/088	9436/968	9476/274	9601/885		
8994/128	9075/465	9157/636	9332/811	9437/677	9478/666	9606/826		
8994/129	9075/466	9157/637	9341/958	9437/678	9478/667	9611/723		
8994/130	9075/467	9157/638	9341/959	9437/679	9482/981	9621/312		
8994/131	9075/468	9157/639	9341/960	9437/680	9484/167	9622/084		
8995/457	9075/469	9157/835	9341/962	9437/681	9485/593	9622/085		
9001/452	9080/872	9166/830	9347/470	9437/682	9485/594	9623/604		
9001/453	9085/531	9166/837	9352/804	9437/683	9491/527	9623/605		
9001/454	9099/906	9169/393	9361/565	9441/160	9495/269	9623/606		
9001/455	9101/032	9169/394	9361/566	9442/494	9498/310	9623/607		
9001/456	9102/501	9181/445	9366/602	9443/117	9500/229	9623/608		
9001/457	9102/502	9181/446	9371/922	9443/118	9500/951	9623/609		
9001/458	9108/040	9208/354	9375/940	9443/119	9500/952	9623/610		
9001/459	9109/388	9210/643	9375/941	9443/120	9500/953	9623/611		
9002/160	9109/389	9210/921	9375/942	9443/121	9501/211	9623/612		

AH462111E

30/08/2010 \$0 201UB



Voi/Foi	Voi/Foi	Voi/Foi	Voi/Foi	Voi/Foi	Voi/Foi	Voi/Foi	Voi/Foi	Voi/Foi	Voi/Foi	Voi/Foi	Voi/Foi
9623/613	9673/428	9728/543	9829/356	9970/948	10075/222	10204/122					
9623/614	9674/805	9728/544	9829/357	9970/951	10079/554	10204/123					
9623/615	9675/726	9728/545	9829/358	9970/952	10079/690	10204/124					
9623/616	9677/740	9728/546	9830/401	9970/953	10083/993	10215/726					
9623/617	9679/029	9728/547	9830/402	9970/954	10086/279	10216/287					
9623/619	9679/033	9728/548	9830/403	9972/230	10086/280	10216/288					
9626/019	9679/311	9740/398	9830/404	9972/231	10090/359	10224/123					
9626/020	9684/869	9742/415	9832/647	9972/232	10090/360	10240/186					
9626/953	9687/142	9746/039	9840/914	9972/233	10090/361	10240/187					
9626/955	9687/143	9748/454	9840/915	9972/234	10090/362	10240/188					
9626/956	9687/144	9748/556	9849/394	9972/235	10090/363	10240/535					
9626/957	9687/145	9748/557	9849/395	9972/236	10090/364	10246/337					
9630/212	9688/099	9748/558	9861/497	9972/237	10090/365	10246/575					
9630/984	9688/101	9750/863	9865/261	9972/238	10091/035	10250/581					
9630/990	9688/102	9759/775	9874/890	9987/218	10091/036	10252/421					
9630/992	9688/103	9759/776	9882/117	9987/219	10091/277	10252/422					
9630/994	9688/104	9759/778	9885/340	9987/220	10092/073	10252/423					
9633/191	9688/105	9759/779	9885/341	9987/221	10092/778	10252/424					
9633/192	9688/106	9759/780	9885/342	9987/222	10092/780	10252/425					
9633/683	9688/107	9760/269	9905/357	9987/223	10096/166	10252/427					
9634/398	9691/598	9764/099	9905/358	9987/224	10098/928	10252/428					
9634/399	9692/231	9764/100	9905/359	9987/225	10099/872	10252/429					
9634/400	9693/576	9764/101	9910/749	9997/135	10100/202	10254/071					
9638/744	9694/005	9765/602	9918/721	10003/280	10105/316	10262/461					
9644/523	9694/335	9765/603	9918/722	10003/281	10105/927	10262/462					
9649/080	9695/440	9766/531	9923/709	10014/256	10105/928	10266/617					
9649/081	9696/624	9766/532	9923/710	10014/257	10106/700	10266/618					
9649/082	9702/390	9767/467	9923/711	10027/604	10109/025	10266/741					
9649/083	9705/352	9768/570	9923/712	10027/605	10109/636	10266/742					
9650/368	9707/102	9768/571	9947/123	10027/606	10109/637	10266/743					
9650/372	9708/147	9769/942	9947/617	10028/646	10112/478	10266/744					
9650/990	9709/028	9770/105	9947/618	10028/647	10112/479	10268/651					
9651/522	9712/250	9770/106	9947/619	10032/880	10112/670	10268/652					
9651/523	9713/988	9770/107	9948/964	10032/881	10112/671	10268/653					
9651/524	9714/155	9774/204	9948/965	10036/124	10112/672	10268/654					
9651/525	9714/156	9775/458	9950/364	10037/611	10112/673	10277/878					
9651/526	9720/177	9792/813	9951/490	10041/276	10112/674	10285/602					
9651/527	9724/873	9793/360	9952/991	10041/277	10115/393	10285/603					
9651/528	9724/874	9793/942	9957/021	10041/371	10120/421	10290/323					
9658/130	9724/875	9793/943	9957/022	10042/477	10129/463	10290/892					
9658/132	9724/876	9795/892	9957/039	10042/478	10130/052	10301/438					
9659/213	9724/877	9800/718	9957/043	10044/151	10130/059	10303/154					
9660/062	9724/878	9800/719	9957/044	10048/733	10131/615	10313/134					
9662/160	9724/879	9806/588	9957/078	10050/965	10153/600	10313/135					
9665/565	9724/880	9806/589	9960/867	10053/295	10153/601	10313/734					
9666/175	9724/881	9811/874	9965/837	10053/790	10153/602	10315/519					
9666/176	9726/419	9814/220	9965/838	10053/791	10154/036	10316/140					
9666/183	9726/420	9820/889	9965/839	10060/124	10156/380	10316/288					
9666/184	9728/023	9821/870	9965/840	10062/529	10156/381	10316/289					
9666/185	9728/024	9823/135	9965/841	10062/530	10159/328	10316/290					
9666/186	9728/025	9823/136	9970/942	10070/496	10162/885	10316/349					
9670/658	9728/537	9823/137	9970/943	10073/293	10164/963	10316/350					
9671/129	9728/539	9823/138	9970/944	10073/294	10175/560	10318/536					
9673/427	9728/541	9824/685	9970/945	10073/295	10185/068	10318/537					
		9826/511	9970/946	10073/296	10190/317	10333/066					

AH46211E

30/09/2010 \$0 20UB



Vol/Fol	Vol/Fol	Vol/Fol	Vol/Fol	Vol/Fol	Vol/Fol	Vol/Fol
10333/067	10526/721	10658/192	10792/448	10946/870	11132/117	
10334/568	10528/300	10662/498	10797/261	10946/871	11132/118	
10335/655	10528/301	10662/905	10797/262	10946/872	11132/119	
10335/711	10531/043	10664/424	10799/136	10946/873	11132/121	
10335/712	10531/176	10685/975	10799/137	10946/874	11132/122	
10344/121	10531/177	10685/976	10800/510	10946/875	11139/257	
10344/122	10531/178	10686/142	10800/511	10946/876	11139/643	
10344/123	10532/115	10686/732	10802/054	10948/003	11139/652	
10344/124	10544/086	10686/733	10802/055	10948/004	11139/655	
10344/125	10545/750	10688/266	10802/058	10959/268	11139/664	
10344/126	10548/731	10688/267	10807/165	10975/323	11139/674	
10344/127	10552/867	10688/269	10813/586	10976/085	11139/675	
10346/494	10556/170	10688/270	10817/337	10988/204	11152/077	
10353/886	10558/304	10693/364	10817/338	10988/545	11161/381	
10354/999	10561/160	10693/365	10817/868	10995/844	11161/384	
10355/000	10561/161	10694/988	10819/698	10995/845	11161/386	
10355/953	10561/162	10694/989	10820/188	10995/846	11164/783	
10369/869	10562/111	10700/037	10820/189	10996/773	11179/263	
10369/870	10562/294	10700/038	10822/044	10996/774	11179/264	
10369/871	10566/432	10703/118	10822/045	11005/306	11179/265	
10374/689	10566/433	10703/119	10828/645	11005/307	11179/266	
10377/057	10566/433	10703/119	10828/646	11005/737	11179/267	
10377/058	10570/229	10705/178	10828/647	11006/657	11179/268	
10377/059	10570/230	10708/397	10831/730	11009/588	11179/269	
10377/060	10571/375	10708/398	10831/731	11009/589	11179/270	
10389/470	10571/376	10709/167	10842/954	11010/176	11179/271	
10390/622	10588/637	10716/689	10842/955	11016/854	11179/272	
10390/930	10593/753	10717/931	10847/300	11016/855	11179/273	
10390/931	10593/754	10717/932	10848/470	11021/249	11179/274	
10394/754	10594/817	10722/615	10849/145	11027/399	11179/479	
10396/229	10611/318	10722/616	10849/430	11033/541	11179/674	
10396/230	10611/319	10725/166	10849/432	11040/580	11182/695	
10397/864	10611/320	10725/167	10850/783	11041/327	11190/398	
10397/865	10611/397	10731/389	10853/767	11041/824	11191/485	
10397/866	10611/398	10737/775	10853/768	11054/168	11191/486	
10397/867	10618/032	10737/776	10854/734	11054/169	11196/226	
10413/619	10620/794	10743/426	10861/940	11054/490	11196/588	
10397/868	10620/795	10743/427	10870/979	11084/517	11208/128	
10422/004	10629/942	10756/924	10870/980	11084/832	11208/177	
10438/885	10632/525	10756/925	10871/183	11084/833	11208/231	
10442/555	10632/526	10757/518	10871/184	11084/870	11208/537	
10444/858	10632/527	10758/481	10875/508	11087/928	11208/608	
10453/741	10632/738	10758/482	10880/402	11088/975	11208/625	
10458/789	10632/904	10760/451	10880/694	11088/976	11209/231	
10460/912	10632/966	10763/699	10893/028	11098/492	9488/220A	
10465/096	10641/468	10773/948	10893/029	11098/493		
10465/836	10641/469	10773/949	10899/206	11103/769		
10469/542	10641/531	10786/540	10899/207	11109/680		
10469/543	10645/136	10786/541	10910/444	11111/297		
10470/800	10646/764	10788/845	10910/445	11115/575		
10470/801	10653/831	10788/846	10915/748	11115/576		
10477/531	10653/832	10788/847	10915/940	11117/092		
10495/800	10655/572	10791/617	10915/941	11117/093		
10498/611	10655/573	10791/618	10939/871	11121/146		
10526/720	10655/732	10791/977	10946/869	11126/028		

CAVEAT

Section 89 Transfer of Land Act 1958

Lodged by:

Name: Gadens Lawyers

Phone: 9252 2555

Address: 600 Bourke Street
MELBOURNE

Reference: MAW:TXG:21067293

Customer Code: 27-C

Privacy Information
The information collected
statutory purpose
searchable registers and indexes.

AH616573J

16/11/2010 \$69.40 89



The caveator claims the estate or interest specified in the land described on the grounds set out and forbids the registration of any person as proprietor of and of any instrument affecting the estate or interest to the extent specified.

Land: *(file, mortgage, charge or lease)*
Volume 9918 Folio 721

Caveator: *(full name and address)*
Invalve Asset Pty Ltd ACN 131 953 823 of 18 Bowman Street, South Perth, 6151, Western Australia

Estate or Interest claimed:
an estate in fee simple

Grounds of claim:
Pursuant to a Contract of Sale dated 11 November 2010 between the Caveator as Purchaser and Ian David Bunting and Paula Alida Bunting as Vendor

Extent of prohibition: *(if not ABSOLUTELY delete and insert desired text)*
Absolutely save and except a transfer to the Caveator

Address in Victoria for service of notice: *(include postcode)*
Gadens Lawyers of 600 Bourke Street, Melbourne, 3000 (Ref: MAW:TXG:21067293)

Dated: 15 November 2010

Signature of caveator

or

Signature of agent being a
Current Practitioner under the
Legal Profession Act 2004

or

Signature of agent

ANTHONY EMIN GREENAWAY
of 600 Bourke Street Melbourne
an Australian Legal Practitioner
within the meaning of the
Legal Profession Act 2004

Approval No: 378098A

DUTY USE ONLY

C

Page 1 of 1

THE BACK OF THIS FORM MUST NOT BE USED
Land Victoria, 570 Bourke Street, Melbourne, 3000, Phone 8636-2010

1

2

TITLE PLAN	EDITION 1	TP 3206B
-------------------	------------------	-----------------

Location of Land
 Parish: TARNHEIT

Notations:

Section: 15
 Crown Allotment:
 Crown Portion: D

LTO base record : PARISH PLAN (3552)
 Last Plan Reference: -----
 Title References: VOL.9918 FOL.721
 Depth Limitation: NIL

Easement Information				
Easement Reference	Purpose/Authority	Width (Metres)	Origin	Land benefited/in favour of

THIS PLAN HAS BEEN
 PREPARED BY THE VICTORIAN
 LAND TITLES OFFICE FOR
 TITLE DIAGRAM PURPOSES

Checked by *ZK*
 Date 5/7/15
 Assistant Registrar of Titles

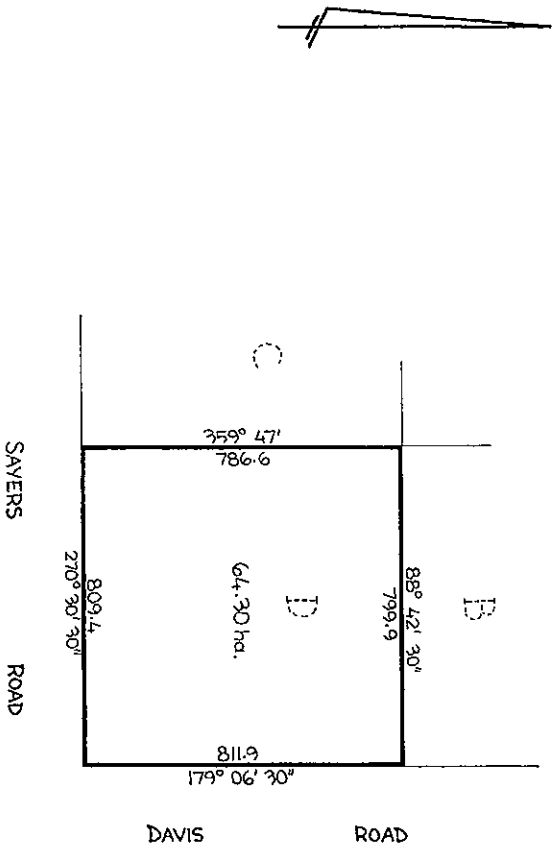

LENGTHS ARE IN METRES	SCALE	SHEET SIZE	FILE No:
		A3	AP74559A

Sheet 1 of 1 Sheet

1

2